

# CONTROL PANEL

CODE:70050

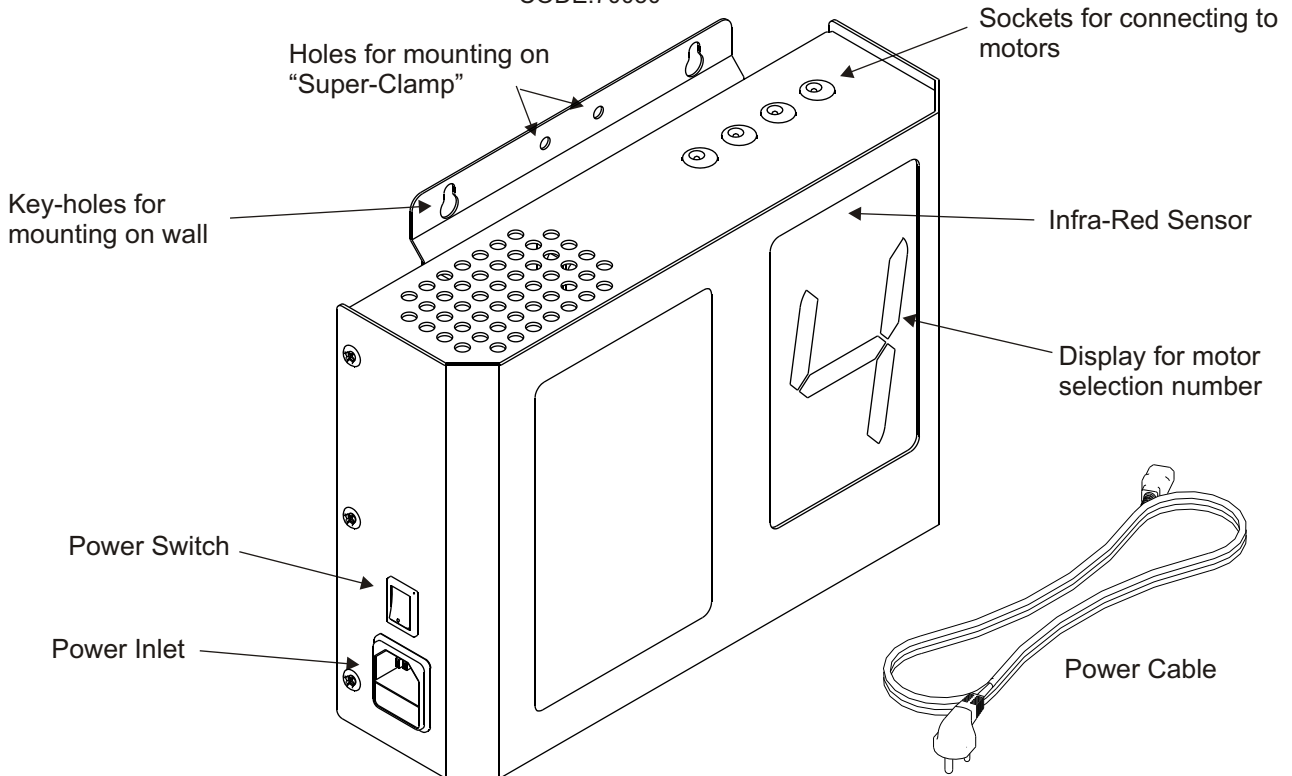
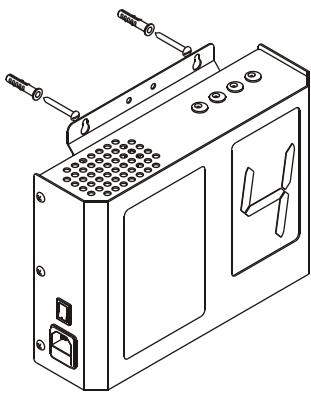
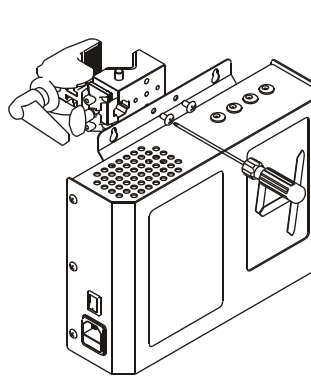
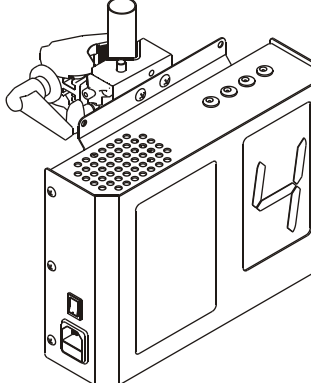

The Control Panel can be mounted on a wall, on "Auto-Poles" or on sturdy light stands. It can drive 4 motorized expanders.

MOUNTING ON A WALL	MOUNTING ON A "SUPER CLAMP"	
 <p>Drill holes in the wall and insert the wall-plugs (provided).</p> <p>Twist the screws into the wall-plugs till about 3/8"(10 mm) is left out.</p> <p>Mount the Control Panel using the key-hole slots.</p>	 <p>The holes provided on the mounting plate of the Control Panel conform in size ( and spacing) to the holes provided on "Super Clamps".</p> <p>Affix the "Super Clamp" as shown using two screws (M5 X 8) using a cross-head (Philips-head) screw-driver.</p> <p>The Control Panel can now be mounted on a tubular structure such as an "Auto-Pole" or a light stand</p>	

**Specifications:**

Input Voltage : 220-240 Volts (110 V AC available upon request)

Output :12V, 5A X 4 outlets

Height of Display : 4 inch