

DIMENSIONS:

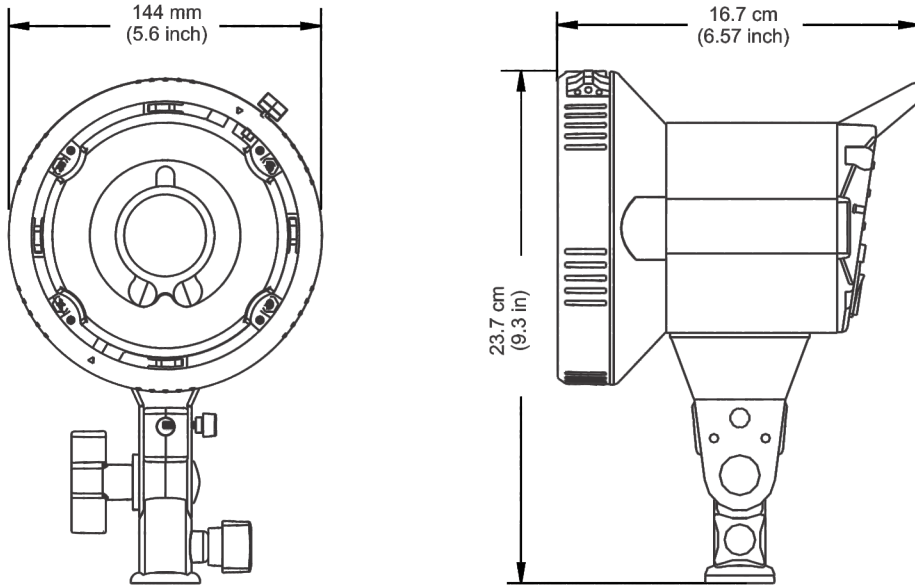

FEATURES:

- Robust metal Body.
- Colour Corrected (Daylight) Light-Output.
- Slave On-Off Switch provided.
- "Plug-and-Play" circuit boards-enabling quick and easy servicing.
- 'E-Type' mount for ease of use with a wide range of light modifiers.
- Compatible with HARISON light supports and light modifiers.

SPECIFICATIONS:

| | |
|-------------------------------------|----------------------|
| Flash output | 125 Watt-secs. |
| F.Stop (reading at 1 meter ISO 100) | 31-1/3 |
| Modelling Lamp | 5 Watt LED |
| Operating Voltage | AC 220-240 V / 50 Hz |
| Weight: | 2.2 kg (4.8 lbs.) |
| Light modifier mount | E-Type |